

Section II.

TM 9-2320-272-34P-1

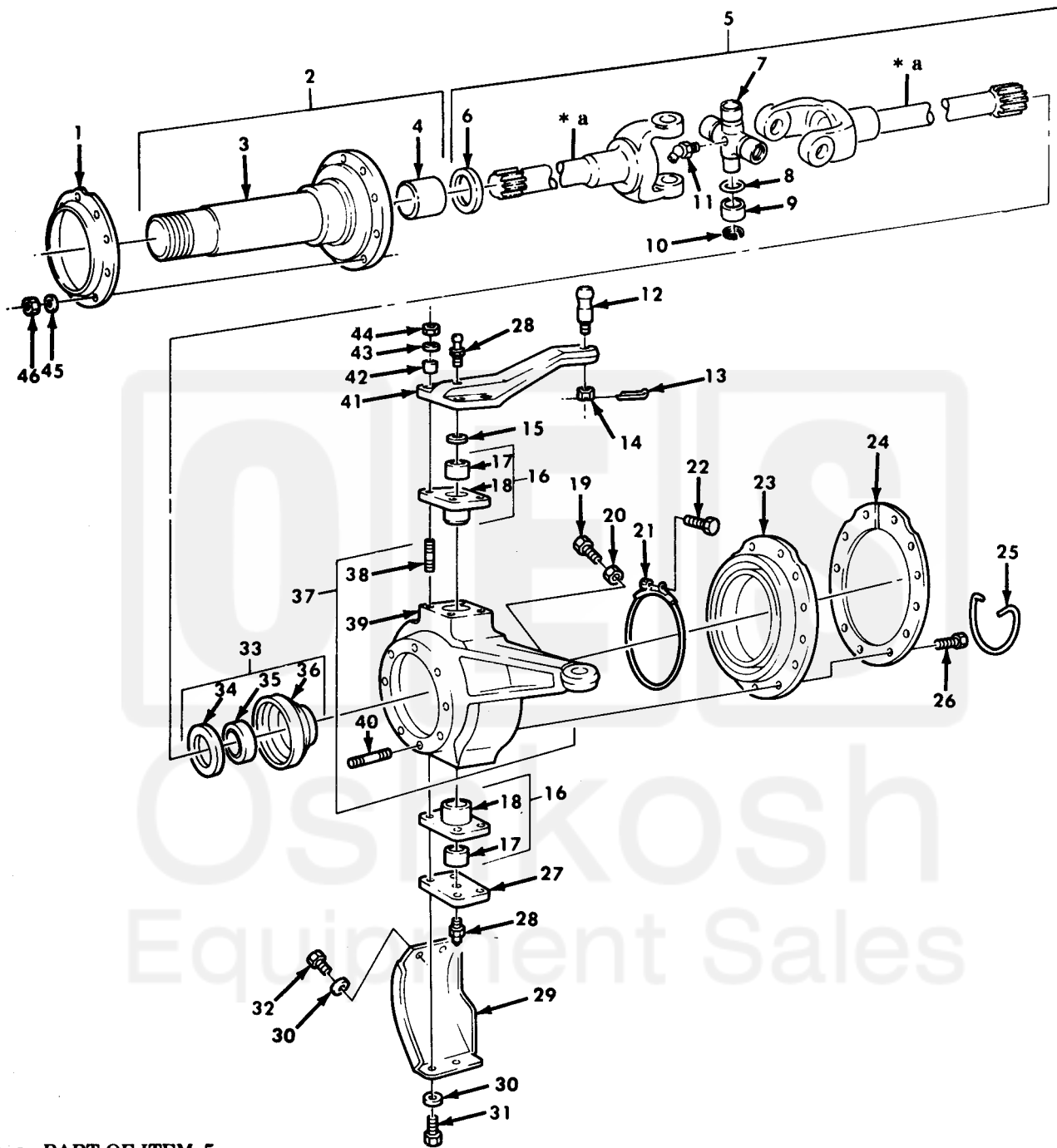

TA 467905

Figure 172. Spindle Shaft Assembly, Universal Shaft, and Knuckle Assembly.

Current part is item (44) on diagram. Available at [www.oshkoshequipment.com](http://www.oshkoshequipment.com)

(1)	(2)	(3)	(4)	(5)	(6)	(7)	(8)
ILLUS.							QTY
(a)	(b)	SMR	NATIONAL	PART	DESCRIPTION	U/M	INC
FIG.	ITEM	CODE	STOCK	NUMBER	FSCM		IN
NO.	NO.		NUMBER			USABLE ON CODE	UNIT
					GROUP 1004 STEERING		
					FIG.172 SPINDLE SHAFT ASSEMBLY, UNIVERSAL		
					SHAFT, AND KNUCKLE ASSEMBLY		
172	1	PAOZZ	2805-01-093-4266	12256157	19207	DEFLECTOR, DIRT AND SPINDLE	EA 2
172	2	PAOFF	2530-00-734-6982	7346982	19207	SPINDLE, WHEEL	EA 2
172	3	XAOZZ		8758276	19207	SPINDLE	EA 1
172	4	PAFZZ	3120-00-537-0614	7346983	19207	BEARING, SLEEVE	EA 1
172	5	PAOOO		A1-3202-G-8093	78500	SHFT, UNIVERSAL LEFT	EA 1
172	5	PAOOO		A1-3202-H-8094	78500	SHAFT, UNIVERSAL RIGHT	EA 1
172	6	PAOZZ	5310-00-033-6007	7346986	19207	WASHER, FLAT	EA 1
172	7	KFOZZ		850N1-4A	78500	CROSS ASSEMBLY PART OF KIT P/N 5704528	EA 1
172	8	KFOZZ		SE-RUR22-2	78500	SEAL PART OF KIT P/N 5704528	EA 4
172	9	KFOZZ		850N4A	78500	CUP ASSEMBLY PART OF KIT P/N 5704528	EA 4
172	10	KFOZZ		850N20	78500	RING, RETAINING PART OF KIT P/N 5704528	EA 4
172	11	PAOZZ	4730-00-172-0031	MS15003-5	96906	FITTING, LUBRICATION	EA 1
172	12	PAFZZ	5307-00-483-1105	11664599	19207	STUD, BALL	EA 1
172	13	PAFZZ	5315-00-298-1481	MS24665-357	96906	PIN, COTTER	EA 2
172	14	PAFZZ	5310-00-835-2140	MS35692-69	96906	NUT, PLAIN, SLOTTED	EA 2
172	15	PAFZZ	5310-00-312-0808	1244B548	78500	SHIM .125	EA V
172	15	PAFZZ	5310-01-054-2568	8758280	19207	SHIM .135	EA V
172	15	PAFZZ	5310-01-128-1592	1224-D-551	78500	SHIM .145	EA V
172	15	PAFZZ	5310-01-134-0209	8758282	19207	SHIM .155	EA V
172	15	PAFZZ	5310-01-134-5791	8758283	19207	SHIM .165	EA V
172	15	PAFZZ	5365-01-055-8769	1224-G-553	78500	SHIM .175	EA V
172	16	PAFFF	2530-00-734-6971	7346971	19207	SLEEVE	EA 4
172	17	PAHZZ	3120-00-288-1889	7346972	19207	BEARING, SLEEVE	EA 1
172	18	XAFZZ		8758253	19207	SLEEVE, STEERING	EA 1
172	19	PAFZZ	5306-00-281-1651	5225875	19207	BOLT, MACHINE	EA 1
172	20	PAFZZ	5310-00-763-8919	MS51967-18	96906	NUT, PLAIN, HEXAGON	EA 1
172	21	PAOZZ	5340-01-118-5972	12300575	19207	CLAMP ASSEMBLY	EA 2
172	22	PAOZZ	5304-00-143-3266	MS27039-0825	96906	SCREW, MACHINE PART OF KIT P/N 5704510	EA 2
172	23	PAOZZ	2530-00-421-7227	8327123	19207	BOOT, DUST PART OF KIT P/N 5704510	EA 2
172	24	PAOZZ	2520-00-734-6975	7346975	19207	RING, DIFFERENTIAL	EA 2
172	25	MOOZZ		22-W-1642-100-40	10001	WIRE MAKE FROM WIRE, P/N 22-W-1642-100	EA 2
172	26	PAOZZ	5305-00-551-5097	MS35265-94	96906	SCREW, MACHINE	EA 24
172	27	PAFZZ	2530-00-734-6974	7346974	19207	COVER, ACCESS	EA 2
172	28	PAOZZ	4730-00-050-4208	MS15003-1	96906	FITTING, LUBRICATION	EA 4
172	29	PAOZZ	2520-00-734-6977	7346977	19207	GUARD, BRUSH KNUCKLE LEFT	EA 1
172	29	PAOZZ	2530-00-734-6978	7346978	19207	GUARD, BRUSH KNUCKLE RIGHT	EA 1
172	30	PAOZZ	5310-00-820-6653	23MS35338-50	80045	WASHER, LOCK	EA 12
172	31	PAOZZ	5305-00-724-7223	MS90728-165	96906	SCREW, CAP, HEXAGON	EA 8
172	31	PAOZZ	5305-00-724-7219	MS90728-160	96906	SCREW, CAP, HEXAGON	EA 4

Current part is item (44) on diagram. Available at [www.oshkoshequipment.com](http://www.oshkoshequipment.com)

Current part is item (44) on diagram. Available at [www.oshkoshequipment.com](http://www.oshkoshequipment.com)

(a) FIG. NO.	(b) ITEM NO.	SMR CODE	NATIONAL STOCK NUMBER	PART NUMBER	FSCM	DESCRIPTION  USABLE ON CODE	U/M	(8) QTY INC IN UNIT
172	33	PAOOO	2520-00-734-6951	7346951	19207	SEAL ASSEMBLY	EA	2
172	34	PAOZZ	5310-00-033-6007	7346986	19207	WASHER, FLAT	EA	1
172	35	PAOZZ	5330-01-132-5312	10938292	19207	SEAL, PLAIN, ENCASED	EA	1
172	36	PAOZZ	5330-01-098-6668	8758268	19207	RETAINER, OIL SEAL	EA	1
172	37	PAFOO	2530-00-734-6815	7346815	19207	KNUCKLE ASSEMBLY LEFT	EA	1
172	37	PAFOO	2520-00-006-7469	7346816-1	19207	KNUCKLE ASSEMBLY RIGHT	EA	1
172	38	PAFZZ	5307-00-734-6900	7346900	19207	STUD, PLAIN	EA	4
172	39	XAFZZ		8758352	19207	HOUSING, FRONT AXLE LEFT	EA	1
172	39	XAFZZ		8758252-1	19207	HOUSING, FRONT AXLE RIGHT	EA	1
172	40	PAFZZ	5307-00-734-6811	7346811	19207	STUD, PLAIN	EA	10
172	41	PAFZZ	2530-01-088-9357	11664597-1	19207	ARM, STEERING LEFT	EA	1
172	41	PAFZZ	2530-00-231-0178	11664598	19207	ARM, STEERING RIGHT	EA	1
172	42	PAFZZ	5340-00-437-2282	7346812	19207	BUSHING, TAPERED	EA	8
172	43	PAFZZ	5310-00-800-0695	MS35335-39	96906	WASHER, LOCK	EA	8
172	44	PAFZZ	5310-00-274-7721	7346813	19207	NUT, PLAIN, HEXAGON	EA	8
172	45	PAOZZ	5310-00-616-6354	MS35335-33	96906	WASHER, LOCK	EA	20
172	46	PAOZZ	5310-00-763-8711	MS51968-17	96906	NUT, PLAIN, HEXAGON	EA	20

END OF FIGURE



Current part is item (44) on diagram. Available at [www.oshkoshequipment.com](http://www.oshkoshequipment.com)